



NORTH ORANGE COUNTY  
COMMUNITY COLLEGE DISTRICT

**Educational & Facilities Master Plan**

**Steering Committee Meeting**

Friday October 11, 2019



moore ruble yudell  
*architects & planners*

# INTRODUCTIONS

# EFMP Project Team



moore ruble yudell  
*architects & planners*



**Andrew Perez**  
Senior Associate, B&D



**Jenny Derry**  
Project Manager, B&D



**Kedarious Colbert**  
Project Analyst, B&D



**Mario Violich, AIA, ASLA**  
Principal, MRY



**Carissa Oyedele, AIA, LEED BD+C**  
Associate Principal, MRY



**Wenjia Xu, AIA, LEED AP BD+C**  
Associate, MRY



**Ty Taylor**  
Project Manager, B&D



**Matt Bohannon**  
Vice President, B&D

# Agenda

1. Introductions
2. Survey Update
3. What is an EFMP?
4. Workshop 1: EFMP Strategic Directions
5. Short Break at 10:15 a.m.
6. Workshop 2: Preliminary Analysis of Forums
7. Upcoming Meetings
8. Adjourn 11 a.m.



# Survey update

	Student Survey	Employee Survey	Alumni/Community Survey
Cypress College	641	69	101
Fullerton College	805	102	119
NOCE	179	55	28
District Services	-	14	-
Other	14	3	18
Completed Surveys	<b>1,639</b>	<b>243</b>	<b>266</b>
In Progress	927	65	69
<b>Total Participation</b>	<b>2,566</b>	<b>308</b>	<b>328</b>
<b>Overall Participation</b>	<b>3,202</b>		

October 10, 2019 Survey Update

# What is an EFMP?

The purpose of an Educational & Facilities Master Plan

## 1. Update Strategic Directions 2020-2030

- Long-range vision for District
- Includes all four entities: Cypress College, Fullerton College, North Orange Continuing Education (NOCE), and District Services

## 2. Agree on broad statements that tell how NOCCCD intends to address current and anticipated challenges









# EFMP Workshop 1

## Previous Strategic Directions

**2.** The District will annually make progress toward eliminating the documented achievement gap among race/ethnicity groups





# EFMP Workshop 1

## Previous Strategic Directions

**3.** The District will annually improve the success rate for students moving into:

- The highest level possible credit basic skills courses in math, English and ESL from noncredit basic skills instruction in the same discipline
- College-level courses in math, English and ESL from credit basic skills courses in these disciplines, and
- The next higher course in the sequence of credit or noncredit basic skills courses in math, English and ESL





# EFMP Workshop 1

## Previous Strategic Directions

**5.** The District will develop and sustain collaborative projects and partnerships with the community's educational institutions, civic organizations, and businesses.



# Questions to answer with your group

- **Is this Strategic Direction resonating with me?**
- **If yes, are the words still right? Does it need to be reworded?**
- **If no, is there a different Strategic Direction that you think is more relevant today?**
- **Is there something missing from the existing Strategic Directions?**





# WORKSHOP ANALYSIS



**CYPRESS  
COLLEGE**



# WORKSHOPS PARTICIPATION

<b>CYPRESS COLLEGE</b>	<b>Location</b>	<b>Student</b>	<b>Classified Staff</b>	<b>Non-Classified Staff</b>	<b>Faculty</b>
<b>Day 1 October 1st</b>	CCC Plex President's Atrium (1:30 – 3:30pm)	<b>58</b>	<b>15</b>	<b>1</b>	<b>15</b>
<b>Day 2 October 2nd</b>	AS Bldg (11:00 am – 1:00pm) CCC Plex President's Atrium (2:00 – 4:00pm)				
Sum Total Participants					
Total Participants					
		<b>89</b>			

# Educational themes: Cypress

## Obstacles Keeping you from Reaching Goals:

- › Classes don't transfer easily between Cypress and Fullerton; no one seems to know how to help
- › Financial insecurities
- › Being hungry or not having access to food
- › Perceived lack of counselors and career-planning
- › Clearer pathways or instructions on fulfilling degree requirements

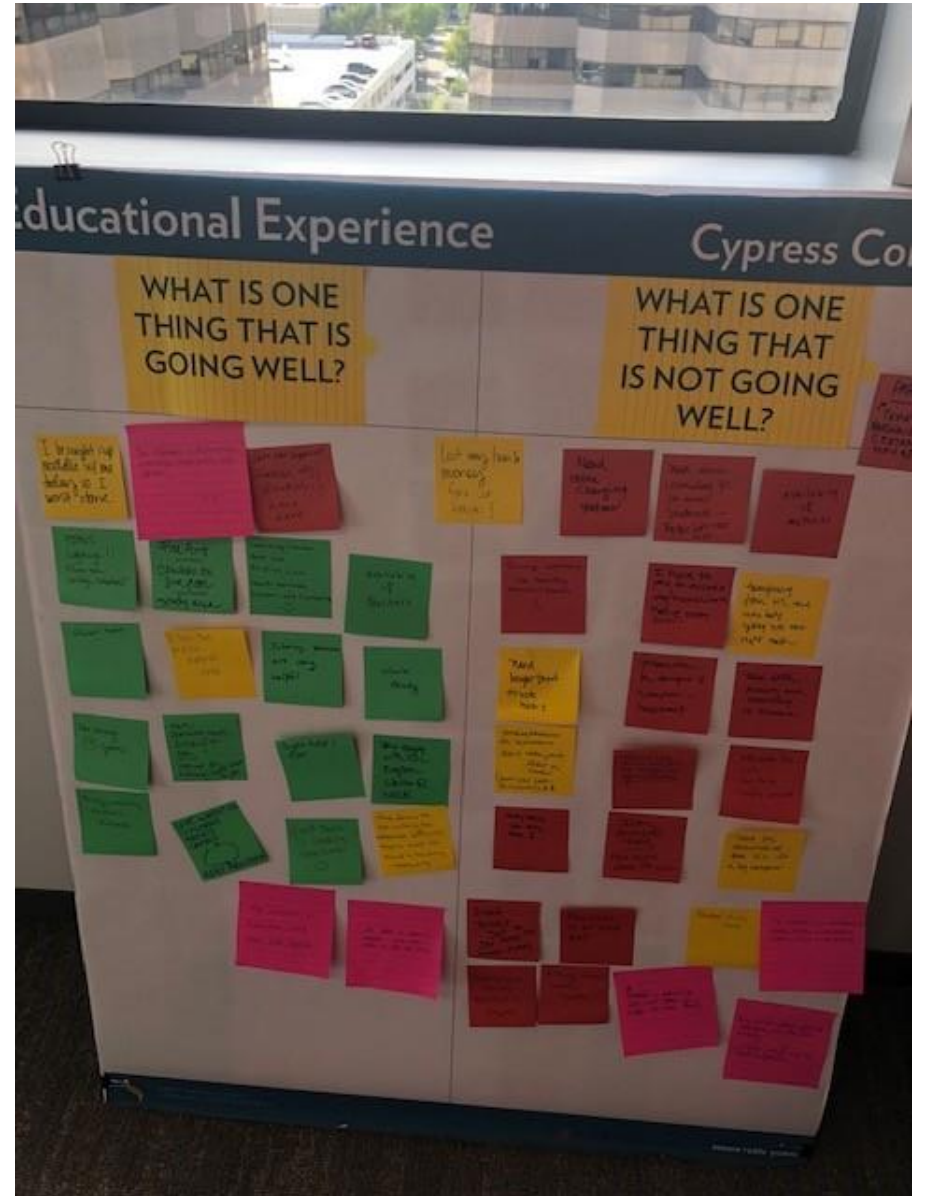

# Educational themes: Cypress

## What is going well?

- › Programs that help students who commute
- › Legacy Program is great but needs banners like the Puente Program; EOPS
- › Math learning center, library first floor
- › Accelerated programs (would like entirely online programs/majors)
- › Financial aid is helping me get through school
- › Administration is willing to tackle food and housing insecurity

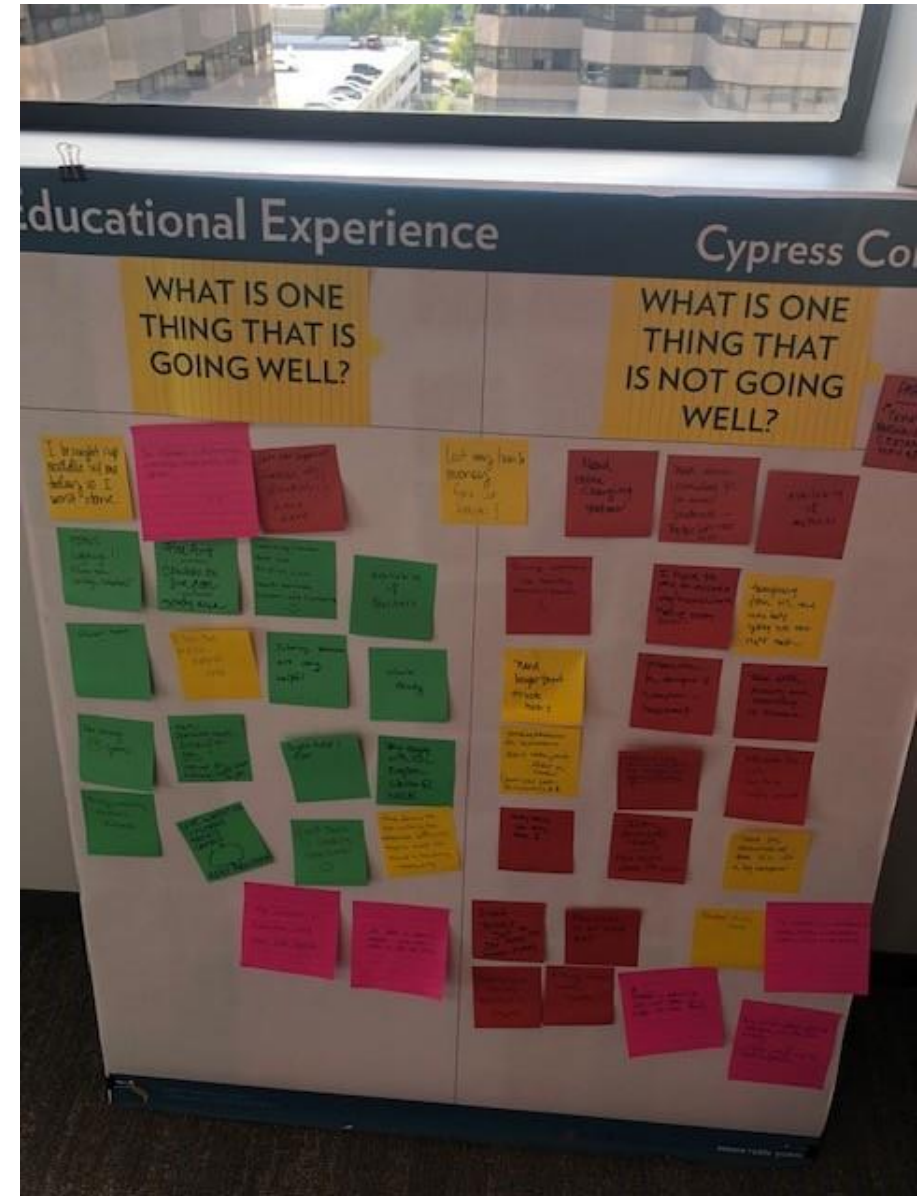

# WORKSHOPS

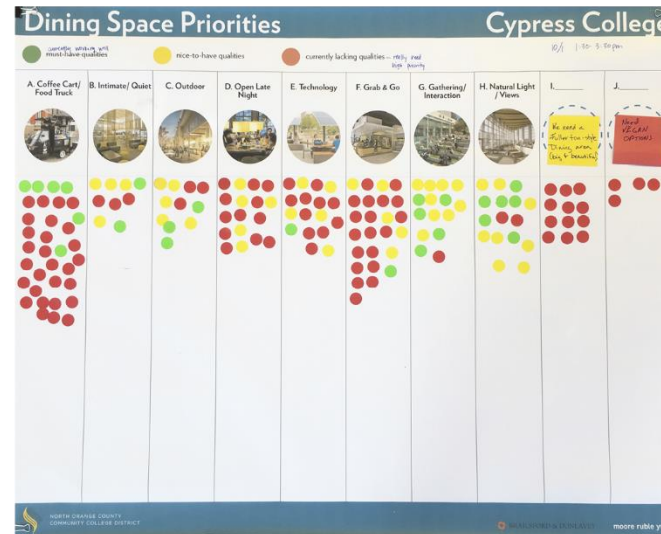
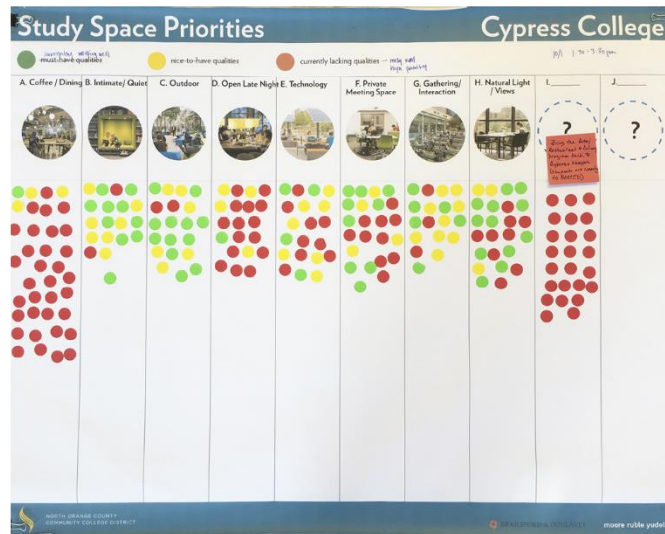
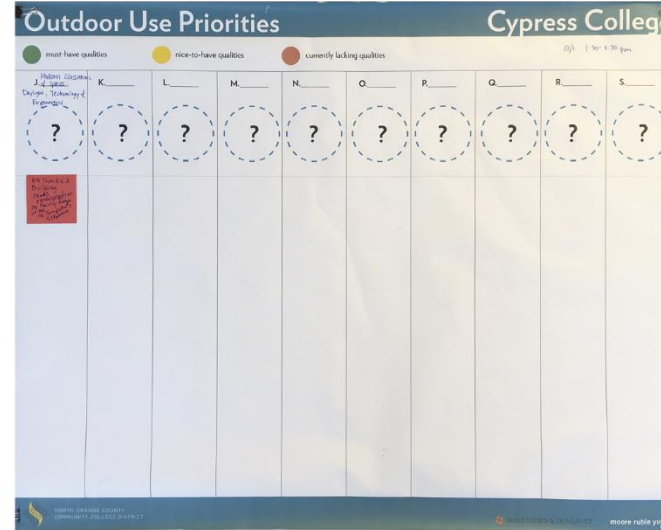
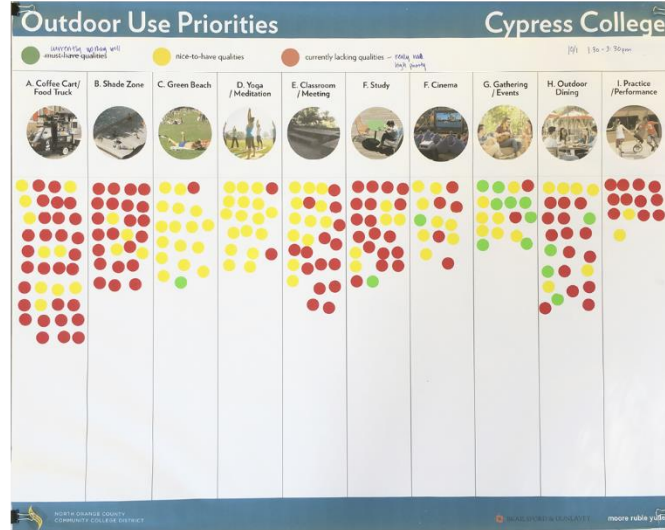



# WORKSHOPS

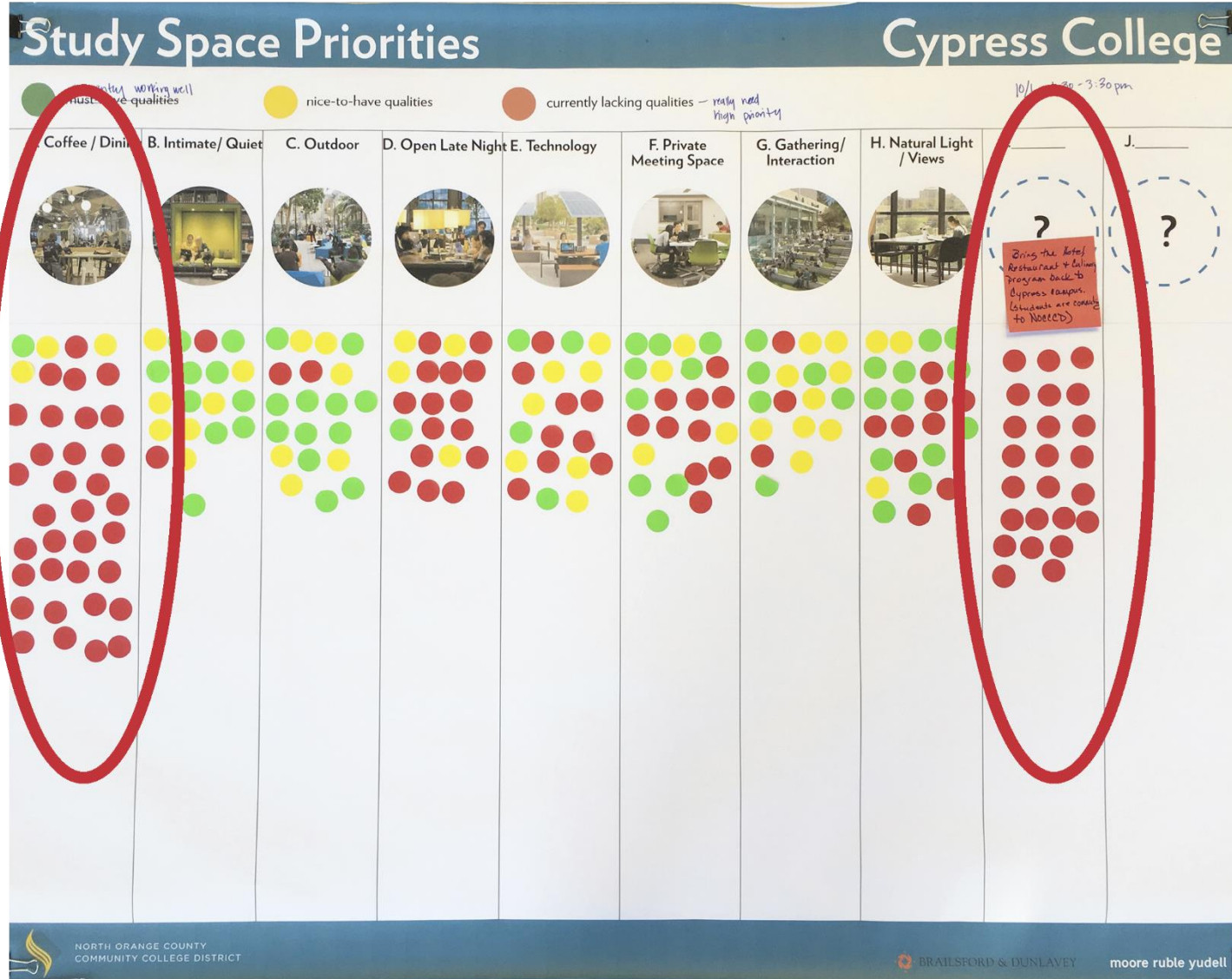

# METHODOLOGY

- **24/7**  
(Amenities, Study Space, Food)
- **Food**  
(Grab & Go, Healthy & Affordable)
- **Study**  
(Quiet & Intimate Study Space)
- **Outdoor**  
(Shade)
- **New Programs**  
(Performing Arts, Meditation/  
Wellness, Gym, Mother's Lounge)
- **Technology Upgrades**





# CAMPUS FLOW

- **Front VS. Back Door** (Security, Comfort, Beauty, Sustainability)
- **Home Base** (Hub, Users, Location, Function)
- **Access** (Shades, Wayfinding, Pedestrian, Parking)



**FULLERTON  
COLLEGE**

# WORKSHOPS PARTICIPATION

<b>FULLERTON COLLEGE</b>	<b>Location</b>	<b>Student</b>	<b>Classified Staff</b>	<b>Non-Classified Staff</b>	<b>Faculty</b>
<b>Day 1 September 30</b>	200 Bldg Room 224 (10:00 am – 1:00pm & 4:00 – 8:00pm)	<b>51</b>	<b>27</b>	<b>10</b>	<b>12</b>
<b>Day 2 October 3rd</b>	200 Bldg Room 224 (10:00 am – 1:00pm & 4:00 – 8:00pm)	<b>30</b>	<b>22</b>		<b>7</b>
<b>Sum Total Participants</b>		<b>81</b>	<b>49</b>	<b>10</b>	<b>19</b>
<b>Total Participants</b>					
		<b>159</b>			

# Educational themes: Fullerton

## Missing from College Experience:

- › Sense of community
- › Child care / emergency child care
- › Lack of staff within student services (counselors) and lack of availability (appointments)
- › Insufficient number of classes (on campus and online)
- › All student services should be available in one building or area so it's not so confusing





# Educational themes: Fullerton

## What is going well?

- › Mindfulness Institute, Mindful Mondays
- › Counseling services
- › Welcome Center and all that is happening at the library
- › Being able to prepare for my career
- › Convenient job on campus so I can study and work in one place
- › Beautiful maintenance of grounds; a beautiful campus



# WORKSHOPS

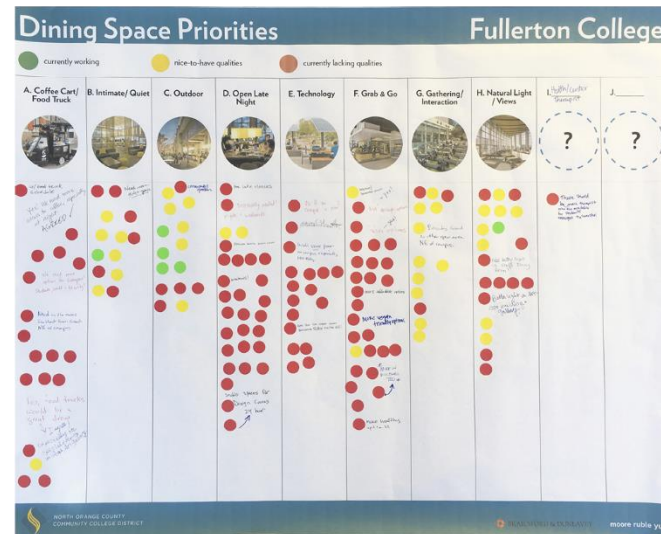
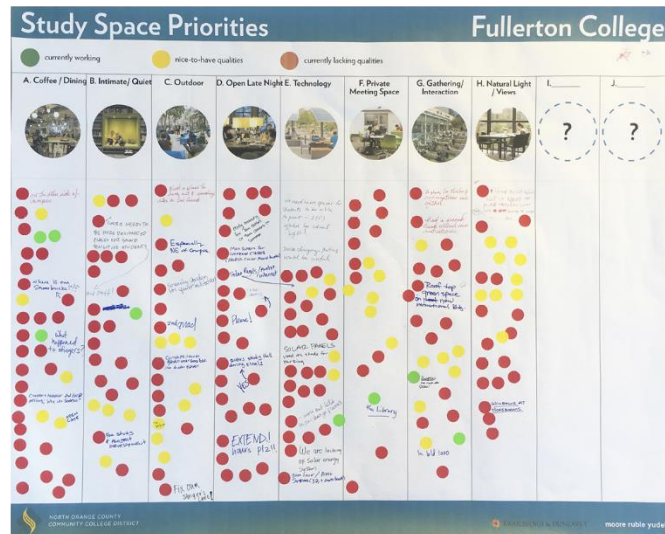
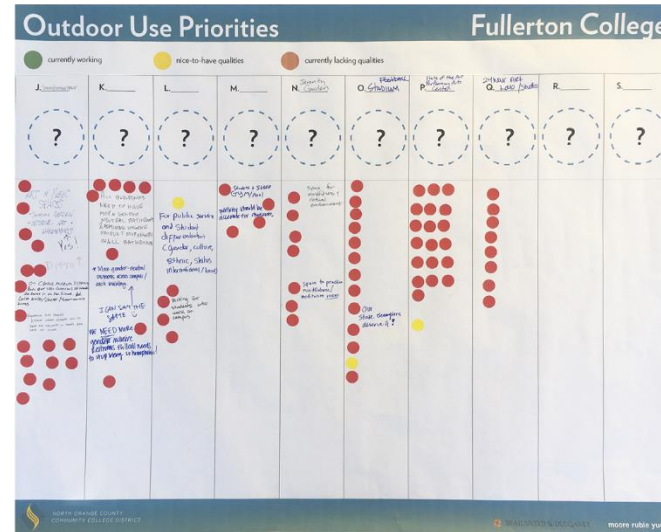
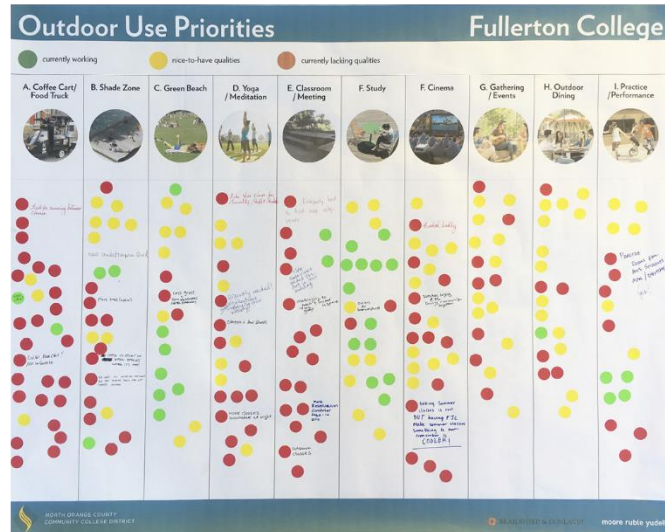



# WORKSHOPS

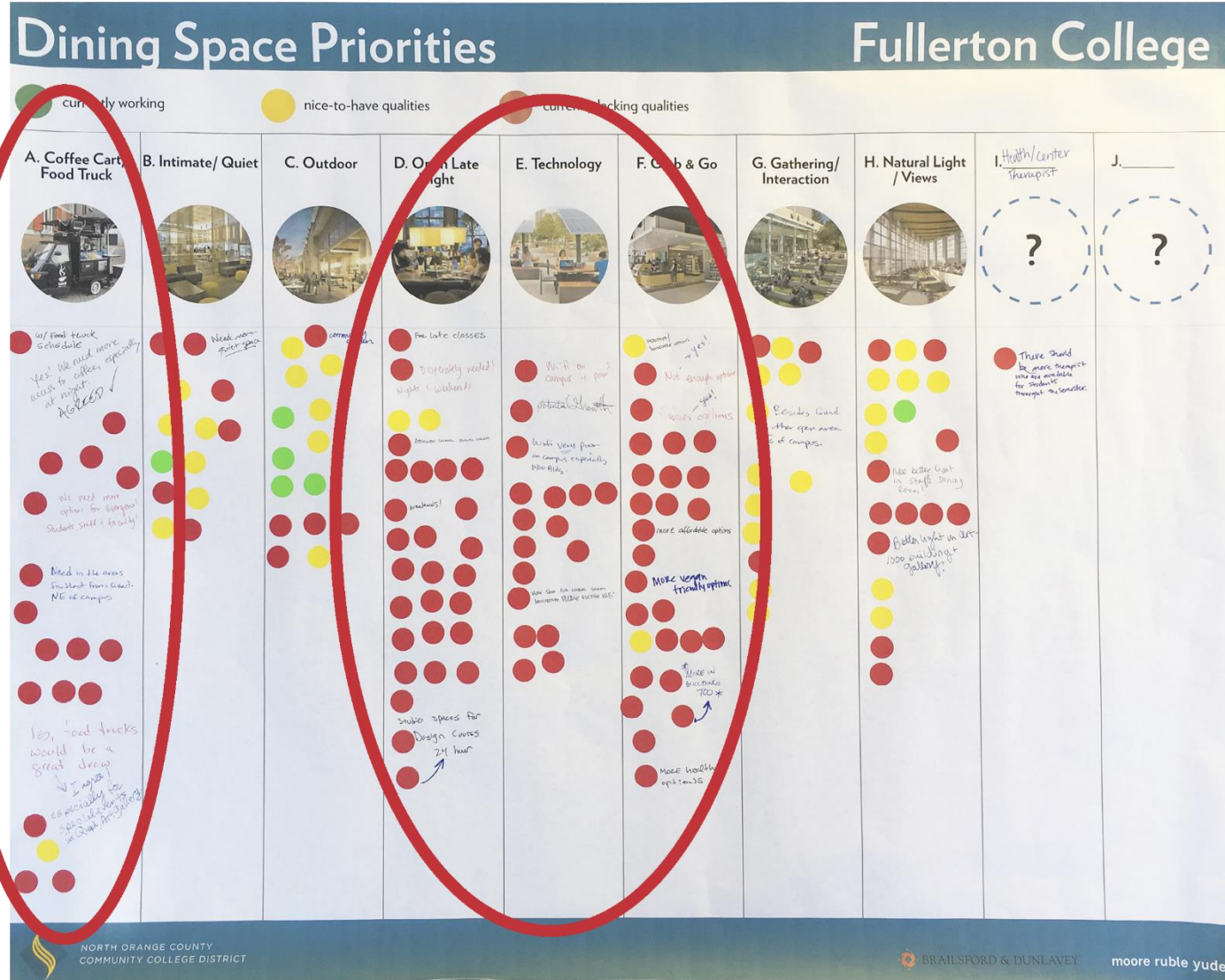

# METHODOLOGY

- **24/7**  
(Amenities, Study Space, Food)
- **Food**  
(Grab & Go, Healthy & Affordable)
- **Study**  
(Quiet & Intimate Study Space)
- **Outdoor**  
(Shade)
- **New Programs**  
(Performing Arts, Meditation/  
Wellness, Gym, Mother's Lounge)
- **Technology Upgrades**





# CAMPUS FLOW

- Shade
- Home Base (Hub, Users, Location, Function)
- Access (Wayfinding, Pedestrian, Parking)

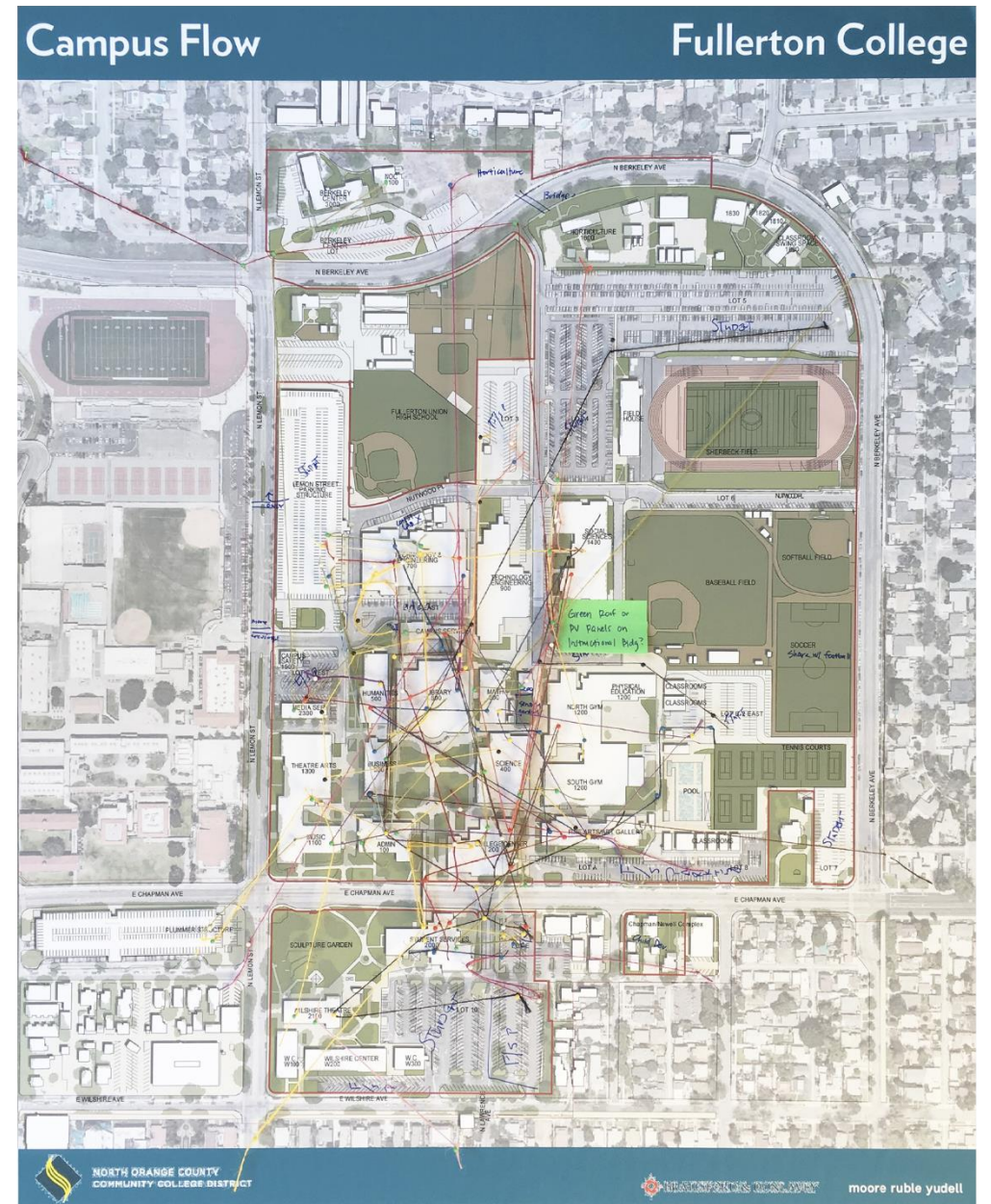

**NOCE**

# WORKSHOPS PARTICIPATION

NOCE	Location	Student	Classified Staff	Non-Classified Staff	Faculty
Day 1 October 8	Room 127 (9:00 – 11:30am & 2:00 – 5:00pm)	70	21	14	4
Sum Total Participants		70	21	14	4
Total Participants		109			



# Educational themes: NOCE

## Obstacles Keeping you from Reaching Goals:

- › Finances as it relates to books or materials costs
- › Transportation to my campus
- › More online educational opportunities
- › Mental health challenges (access to mental health services needed)
- › Updated equipment and more storage area for programs like Medical Assistant & Pharmacy Technician



# Educational themes: NOCE

## What is going well?

- › Career Resource Center that serves all students including those who are undocumented
- › Flexible schedules that work for people with jobs
- › English classes
- › Staff are very supportive of students
- › Excellent teachers
- › Open consultation about difficult topics is welcomed on all levels
- › ESL is free; desire for an additional advance level



# WORKSHOPS

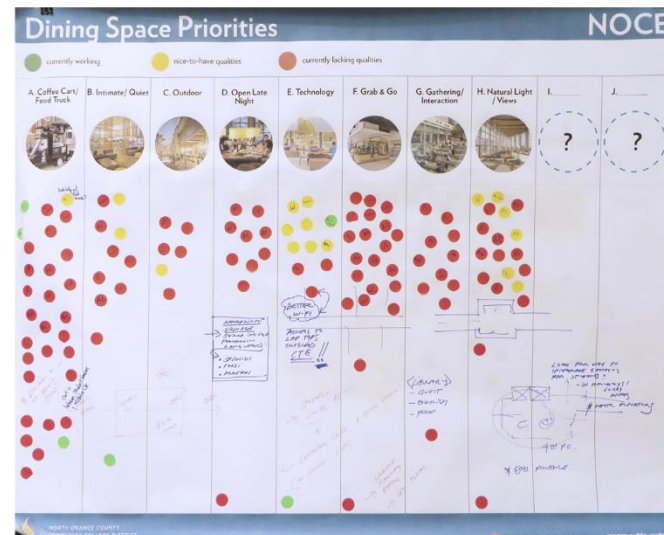
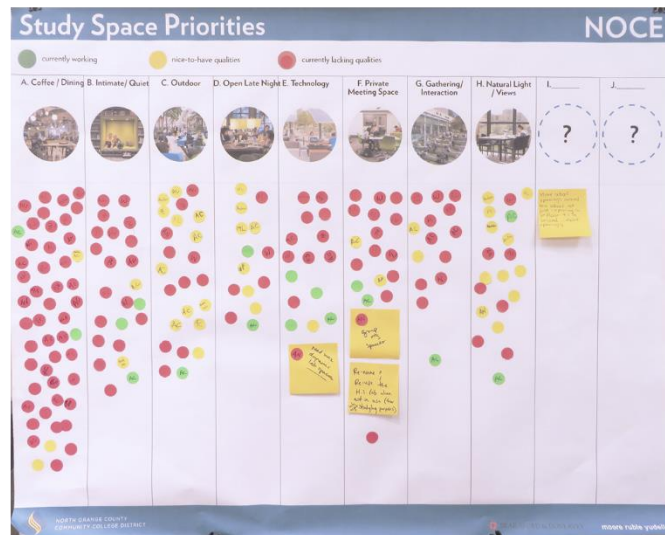
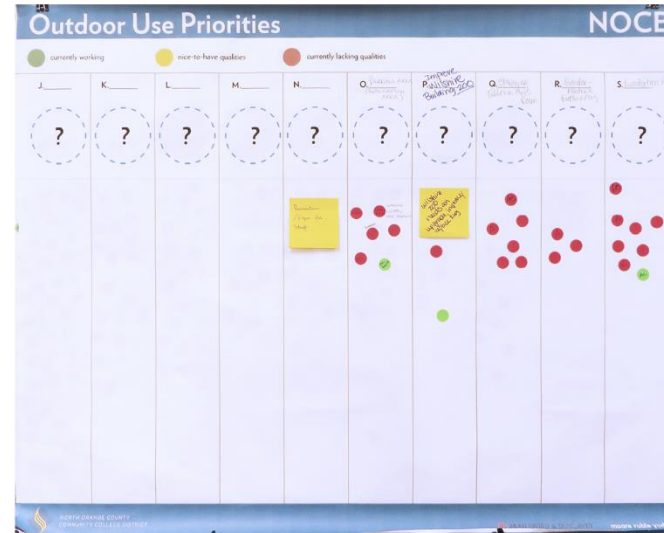
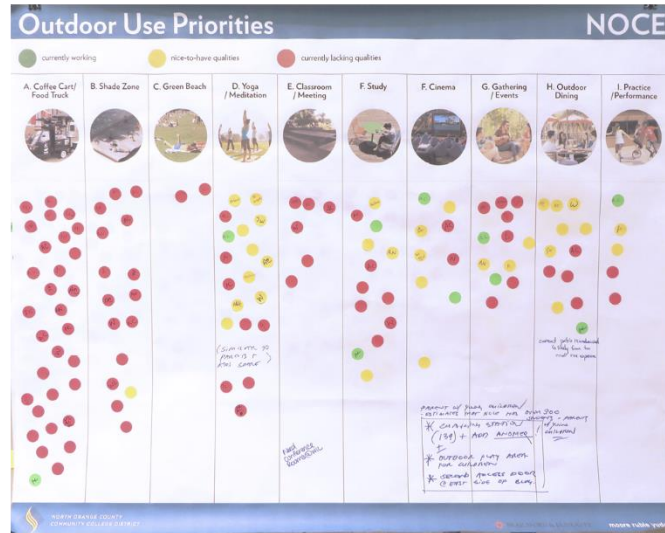





# METHODOLOGY

- **Food** (Dining, Coffee, Adjacent Food)
- **Study** (Quiet & Intimate Study Space)
- **Outdoor** (Shade)
- **New Programs** (Gender Neutral Bathroom, Mother's Lounge, Children Care)





# CAMPUS FLOW

- Vehicle & Pedestrian Intersection
- Outdoor Space with Shading
- Wayfinding
- Home Base (Hub)

Campus Flow

NOCE

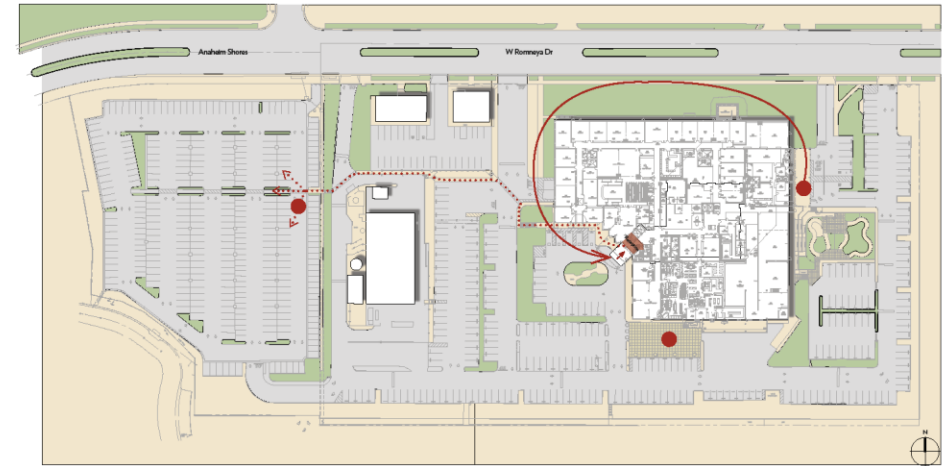

FIRST FLOOR

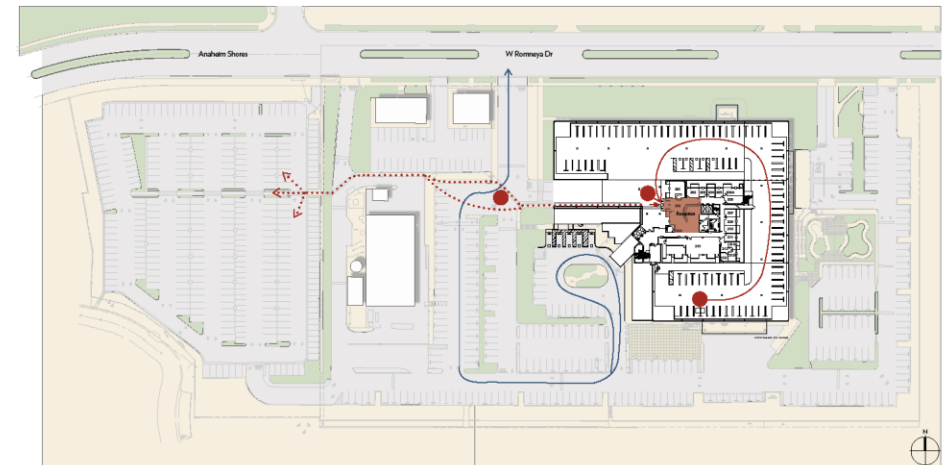

SECOND FLOOR

# Food for thought for our Next Steering Committee Meeting

- November 1
- 9:30 to 11 a.m.



**THANK YOU**

# Who We've Met

## FULLERTON COLLEGE

Faculty Senate  
President's Advisory Council  
President's Staff  
Facilities Team Meeting  
Student Equity Walk Group  
Open Forum

## CYPRESS COLLEGE

Academic Senate  
President's Advisory Council  
President's Cabinet  
Facilities Team Meeting  
Associated Students  
Open Forum

## NOCE

Academic Senate  
Provost's Cabinet  
Management Team  
Adjunct Faculty Training

---

## DISTRICT WIDE

Manager's Retreat  
District Consultation Council  
Measure J Facilities Team Meeting  
Board of Trustees Presentation  
Educational Services & Technology  
Strategic Asset Value Sessions

# Future Meetings

## FULLERTON COLLEGE

President's Advisory Council  
Fullerton Classified Senate  
Diversity Committee  
Curriculum Committee  
Guided Pathways  
Program Review  
Associated Students  
Disability Support Services

## CYPRESS COLLEGE

President's Cabinet (2<sup>nd</sup> Visit)  
Faculty Senate (2<sup>nd</sup> Visit)  
Diversity Equity & Inclusion  
Curriculum Committee  
Guided Pathways  
Program Review

## NOCE

Management Team  
Faculty Senate  
CAPE  
Curriculum Committee  
Disability Support Services  
Open Forum

---

## DISTRICT WIDE

Guided Pathways Steering Committee  
VP Council  
Open Forum  
Steering Committee Meetings  
District Consultation Council  
Board of Trustees Presentation



# MASTER SCOPE / VISION

- Developing One Plan
  - 75% Education
  - 25% Facilities
- Building Upon Past Plans
- Visioning / Data Gathering
- Engagement
- Documentation & Approvals



# NOCCCD



CYPRESS

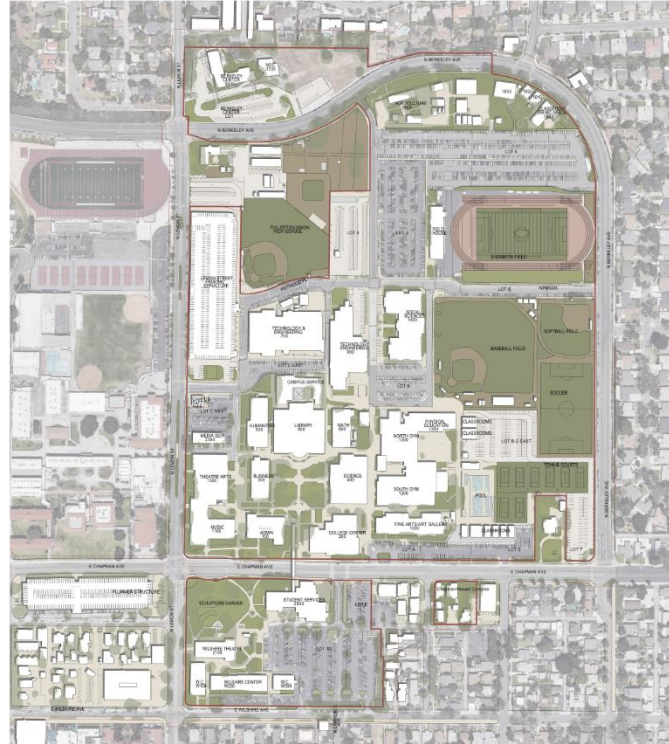

FULLERTON

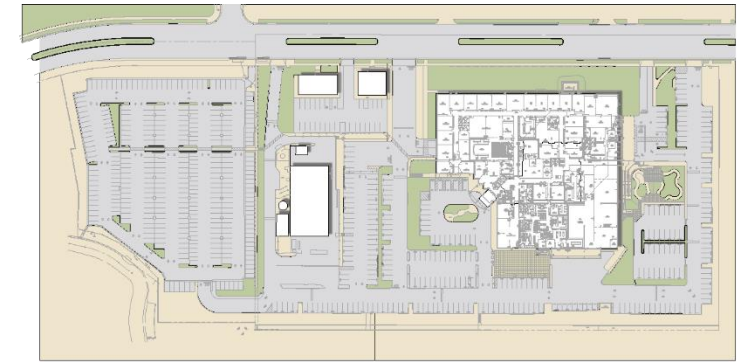

NOCE



# CYPRESS COLLEGE

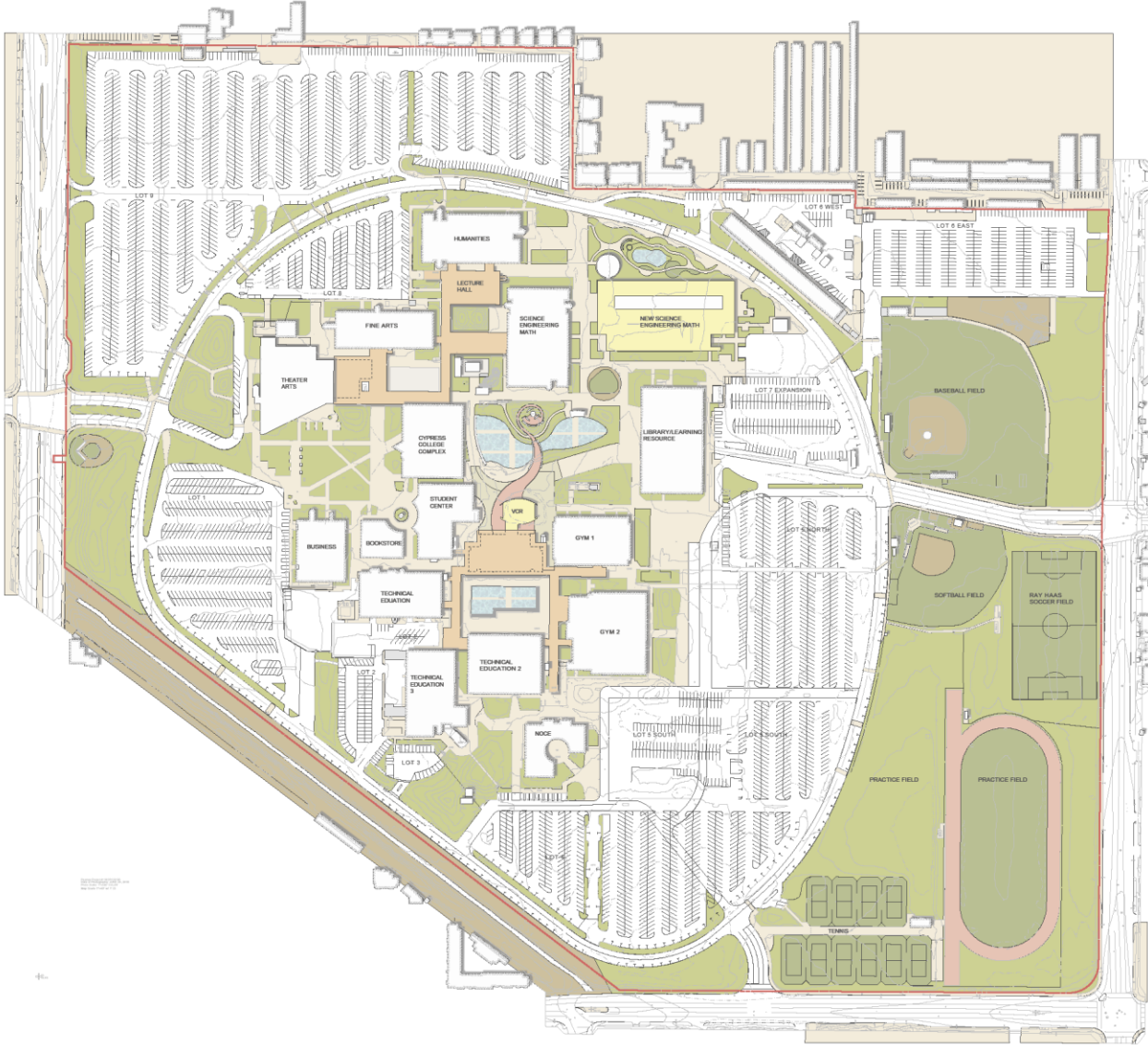

# CYPRESS COLLEGE MEASURE J

- SEM Building
- Veterans Resource Center and Student Activities Center
- Veterans Memorial Plaza
- Pond Refurbishment
- Fine Arts Capital Improvement
- Update/Improve Infrastructure
- Library-Learning Resource Center Expansion
- Mass Communications & Security Systems Upgrade
- Gym I/Gym II Restoration
- Tech I/Tech III Capital Improvements

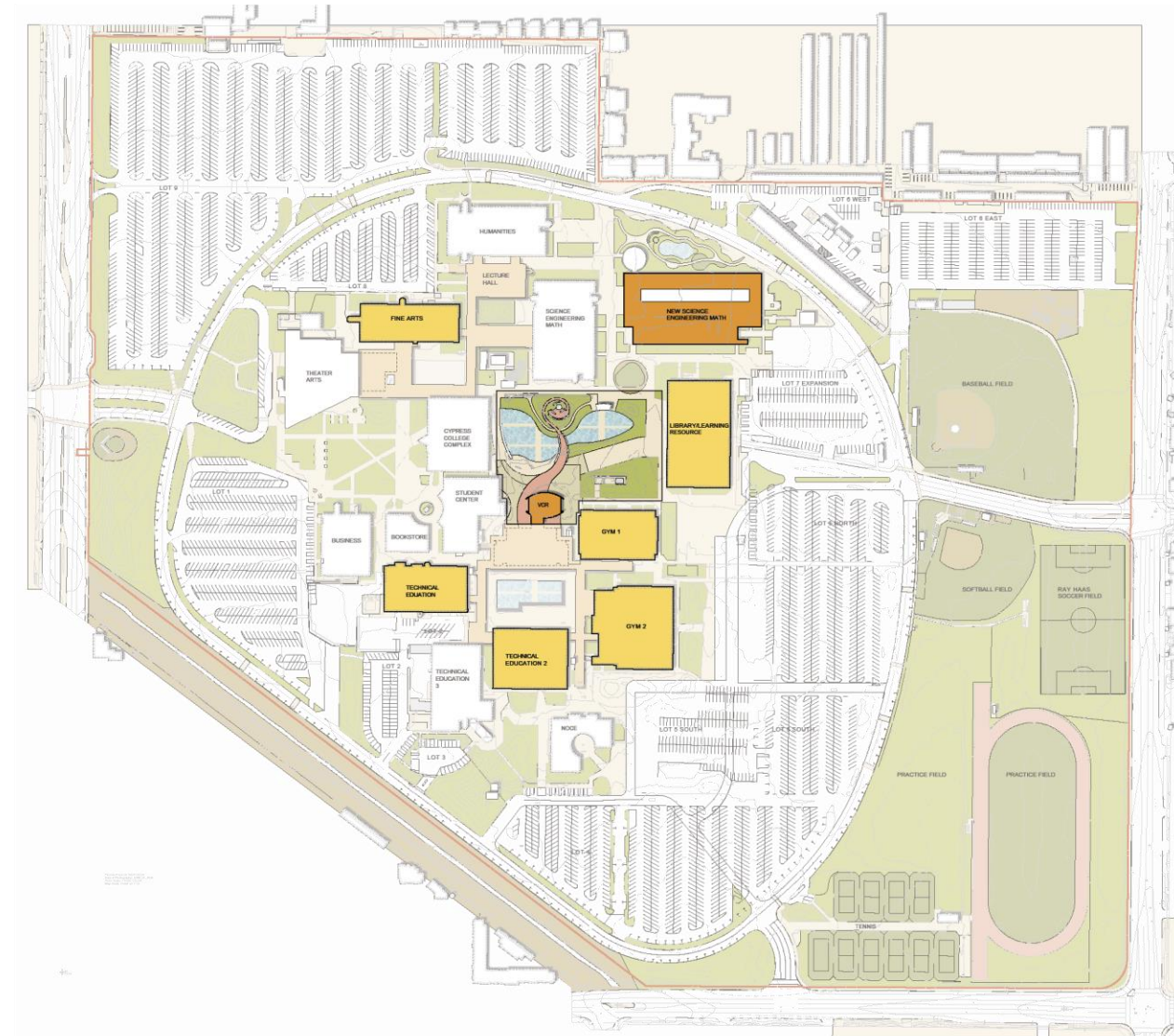







# FULLERTON COLLEGE MEASURE J

- Classroom/Instructional Building
- Horticulture Center
- CDES Lab School (Early Childhood Education Center)
- Parking Structure
- Performing Arts Center (Theatre and Music Buildings)
- Renovations of the buildings 100, 300, 500, 600, 840, 1000, Whilshire Theatre, Health Center, Faculty Offices, Wellness Center
- Welcome Center (student and veterans services building)
- Upgrade / Improve Infrastructure

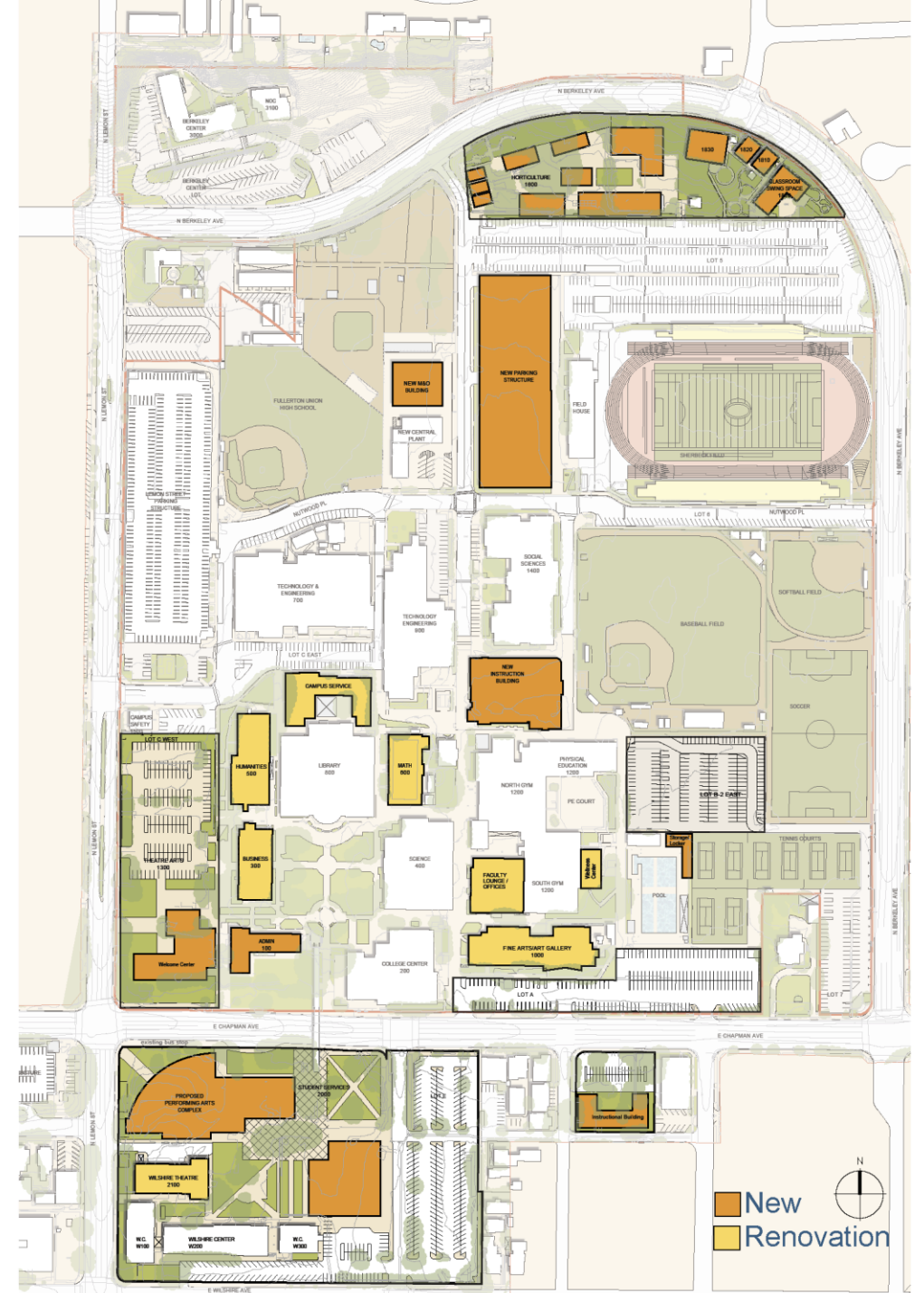

# NOCE

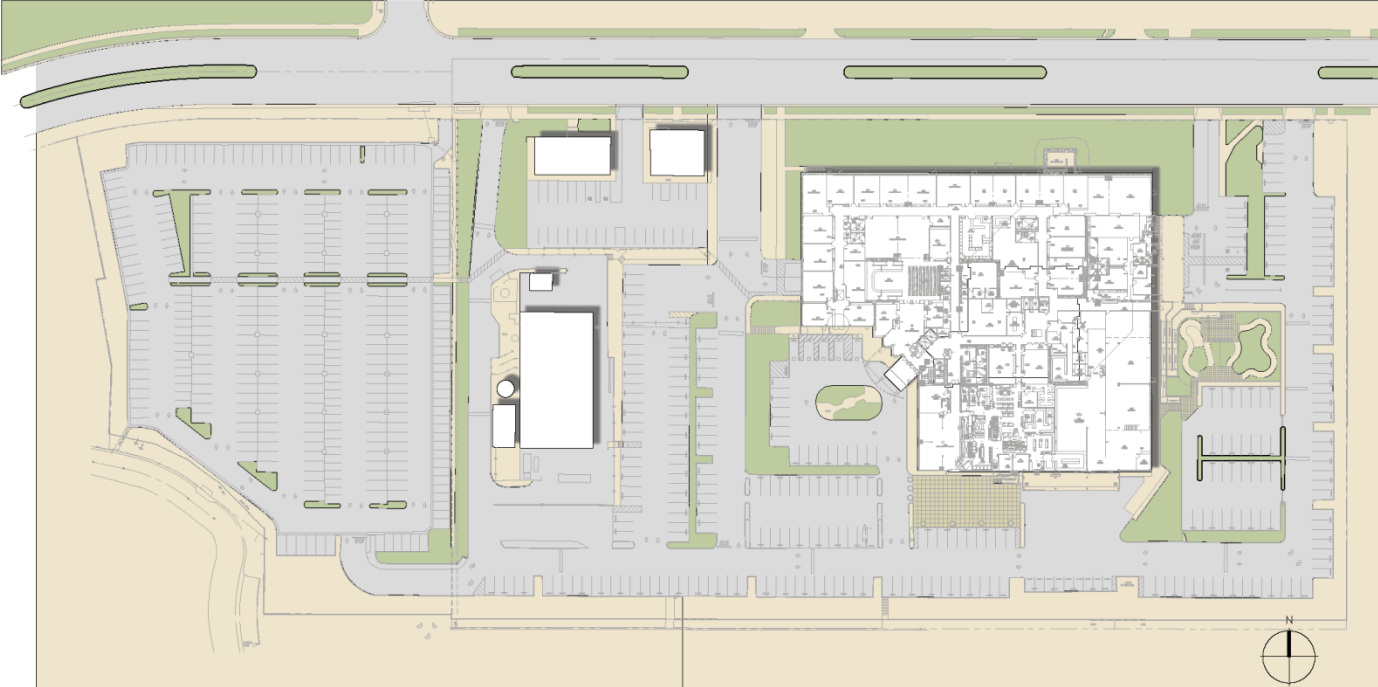

# NOCE MEASURE J

- 7th and 10th Floors Buildout
- 5th Floor CTE Laboratory and 2nd Floor Counseling Office Room 215 TI
- Update / Improve Infrastructure

